

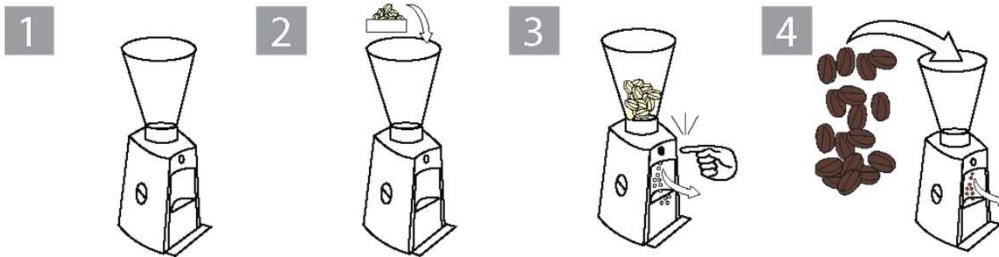

WEEKLY CLEANING INSTRUCTIONS



1. Empty all coffee from grinder.
2. Add Grindz grinder cleaner per usage information below.
3. Adjust grinder to medium setting and operate.
4. To purge, repeat above process twice with coffee.
5. Repeat if desired.



DOSAGE INSTRUCTIONS

Use one (1) capful (35-40 g) for espresso grinders

Use two (2) capfuls (70-80 g) for portion control / shop grinders.

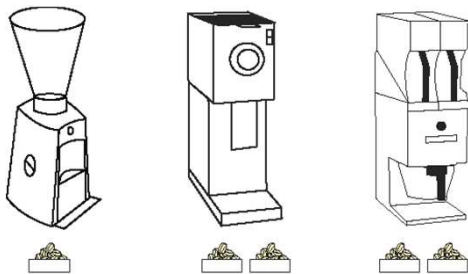

CLEANING CYCLE

- It is recommended to use Grindz for shop grinders once a month
- And for espresso grinders once a week or every 15 kilos of coffee.
- For the complete cleaning process only a few minutes are needed.

NOTE

- Dust may develop during grinding and is harmless.
- Wipe particulates from hopper, spout and doser.
- Keep container tightly closed and dry.