



DAILY CLEANING INSTRUCTIONS



BACKFLUSH (EACH GROUP HEAD)

1. Insert blind filter in portafilter and add 3 g Cafiza powder. Insert portafilter into group head.
2. Activate brew cycle for 10 seconds. Stop 10 seconds. Repeat 5 times.
3. Remove portafilter. Activate brew cycle and rinse porta-filter in stream of water from group head. Stop cycle.
4. Insert portafilter into group head. Repeat step (2) without Cafiza powder 5 times.
5. Make and discard a cup of espresso to ensure no residue remains.

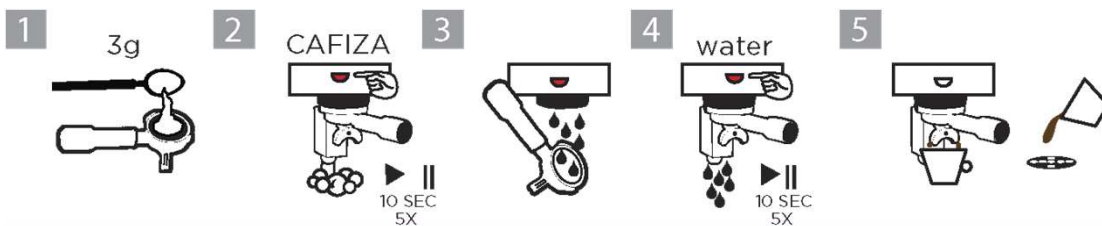

SOAK PORTAFILTERS, SCREENS, AND DIP TRAYS

1. Use one (1) teaspoon (6 g) of Cafiza powder in a large container or tray containing 1 liter of hot water (select a vessel large enough to submerge the dirty metal parts – not plastic handle.)
2. Allow parts to soak in solution for up to 30 minutes.
3. Empty vessel and rinse all parts with clean water.

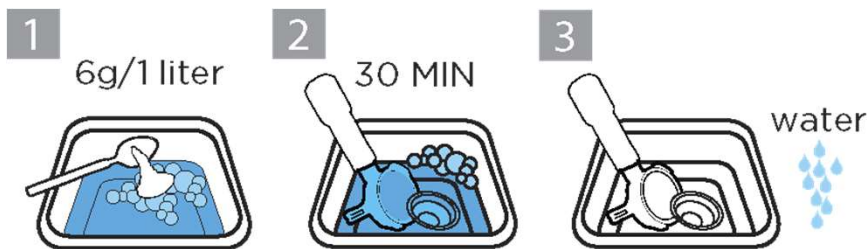

STEAM WANDS

1. Mix one (1) Rinza M61 tablet or (15) ml Rinza Liquid per 8oz / 250 ml water.
2. Heat with steam wand and allow solution to back syphon into steam wand.
2. Soak parts or steam wand for 15-30 minutes in solution.
3. Rinse all components.



For steam wands

